

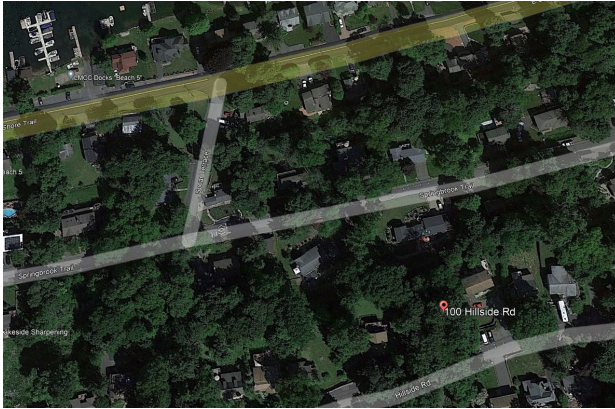

The Lake Mohawk Country Club

21 The Boardwalk
Sparta, New Jersey 07871

1. 100 Hillside Road - non-buildable & extremely steep, good candidate for membership lot w/o conditions



2. 104 Hilltop Trail – non-buildable, access to Helen Morgan School property, good candidate for membership lot w/ conditions for LMCC stream maintenance and conservation.

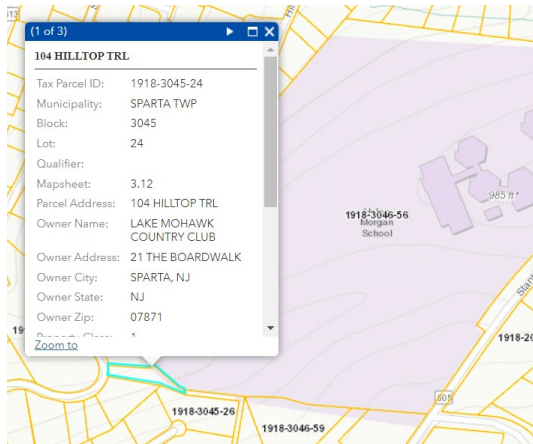

3. 14 Mosswood Terrace - non-buildable, good candidate for membership lot w/o conditions

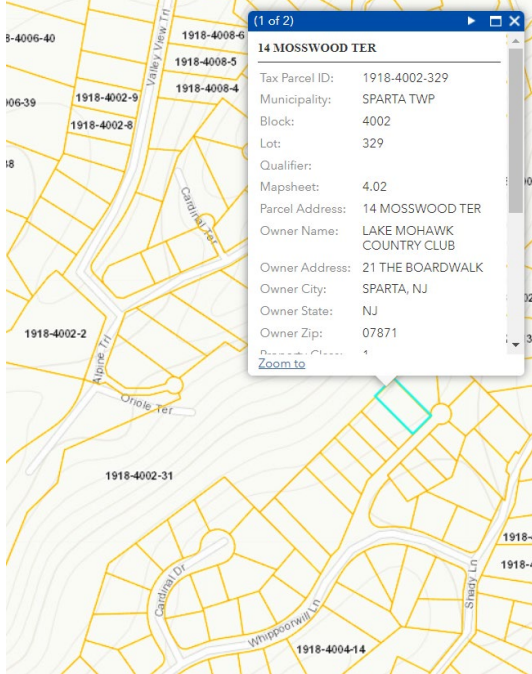

4. 61 Park Road – drainage path for Park & Woodlawn intersection, fair candidate for membership lot w/ conditions – easements & LMCC infrastructure improvements. Also partially used by adjacent property, 63 Park.

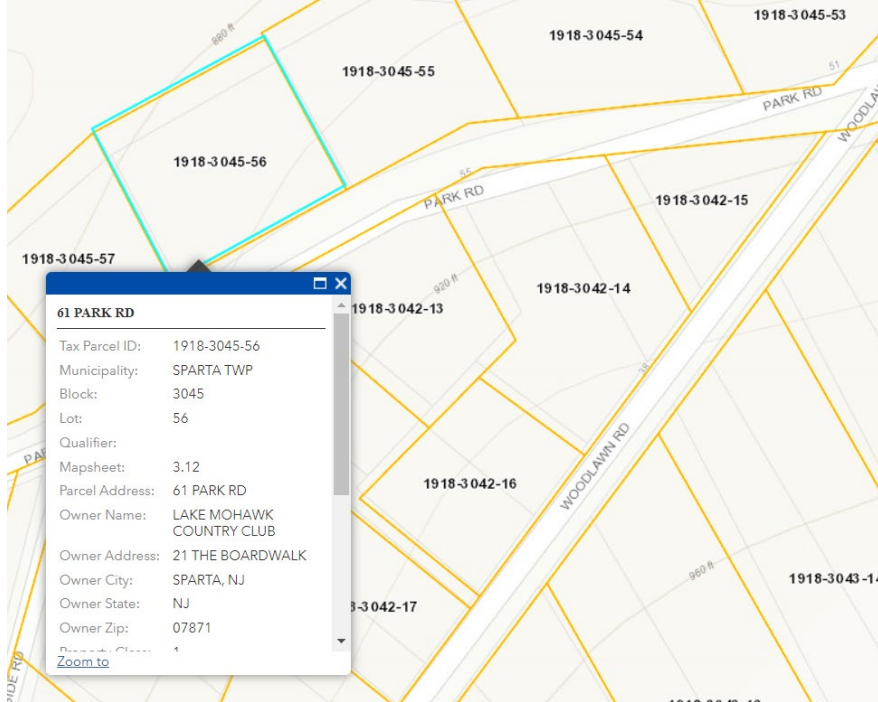



- 5. South Shore Trail no issues for access or LMCC use. Good candidate for sale to adjacent property owner – 23 South Shore Trail.

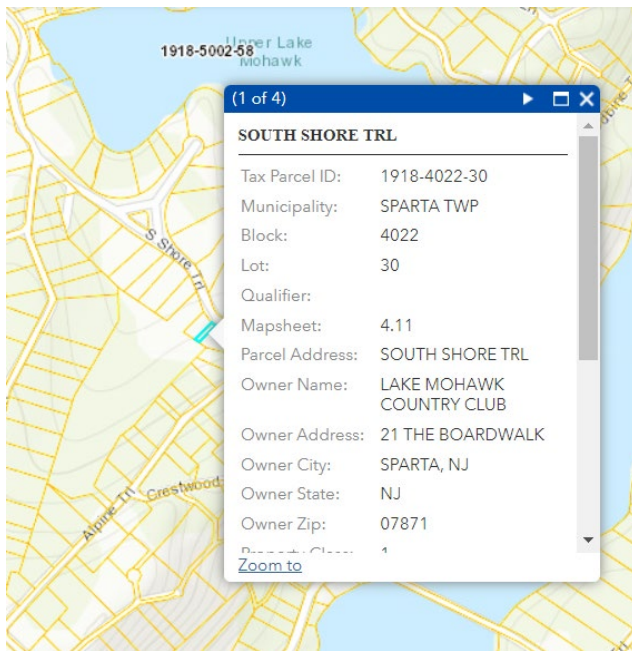

6. 89 Springbrook Trail- drainage path & access to ravine, fair candidate for membership lot w/ conditions – easements & LMCC infrastructure improvements. Better candidate for parkland/bridle path use between Hilltop & Springbrook.

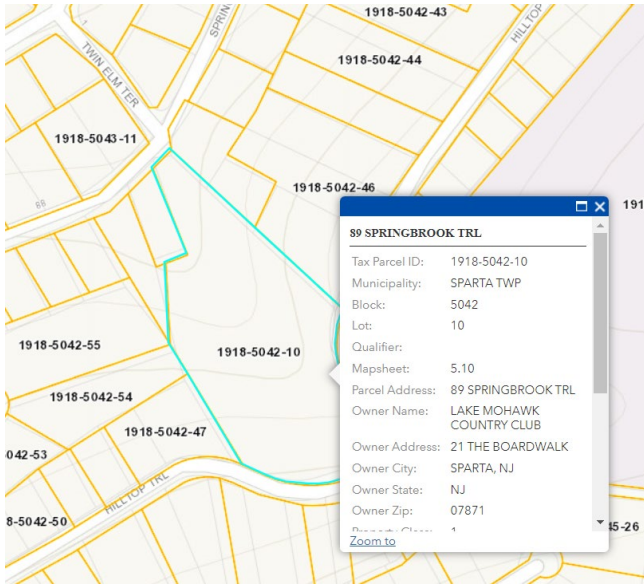

7. 103 Glenside Trail – access to power lines, good candidate for sale to adjacent properties as it is already being used and maintained by them.

